

**A**

**#1 Power wire coming into fixture, connect this to #2 Power wire going to 3 way switch with wire nut.**

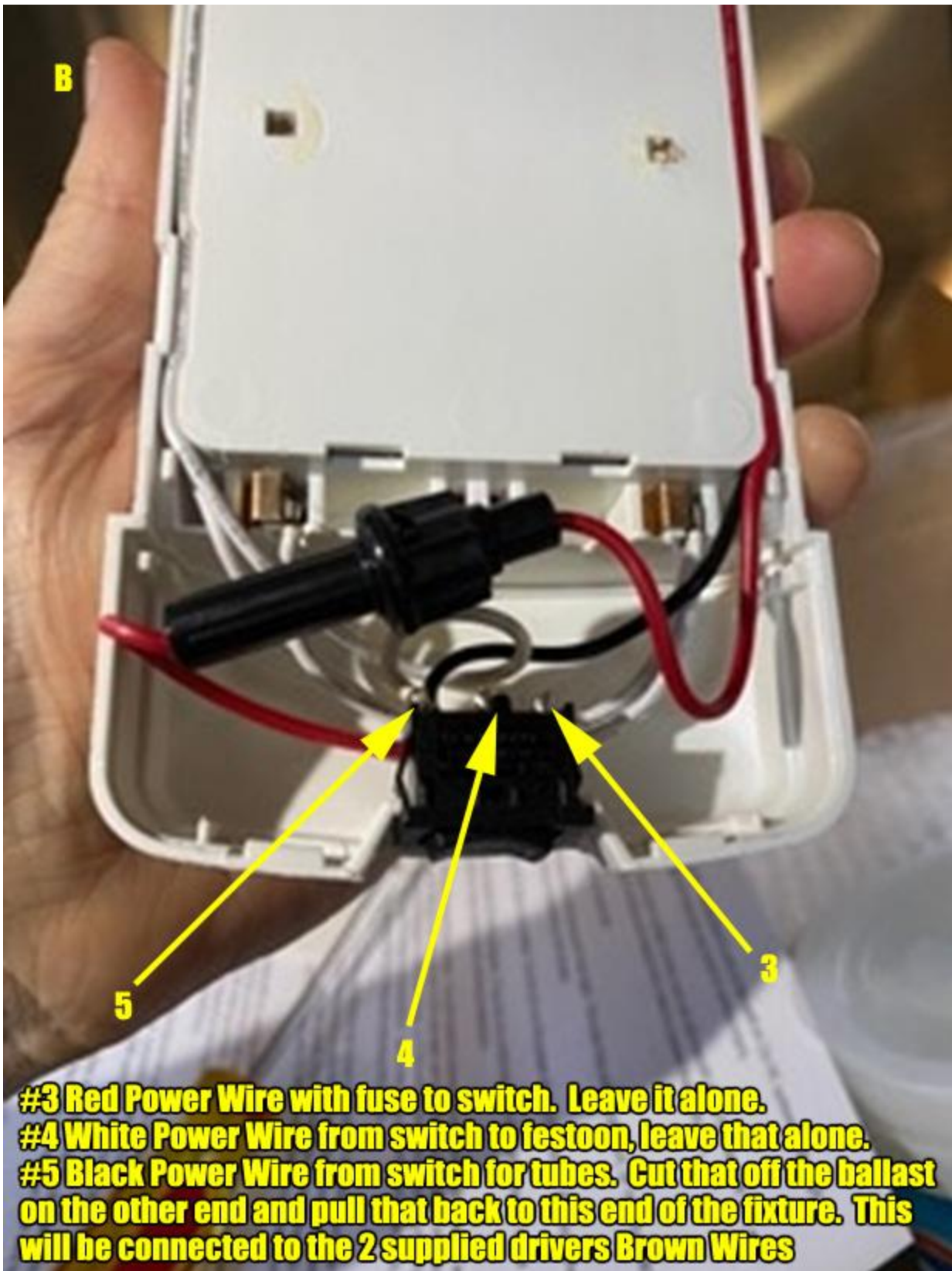



**c**

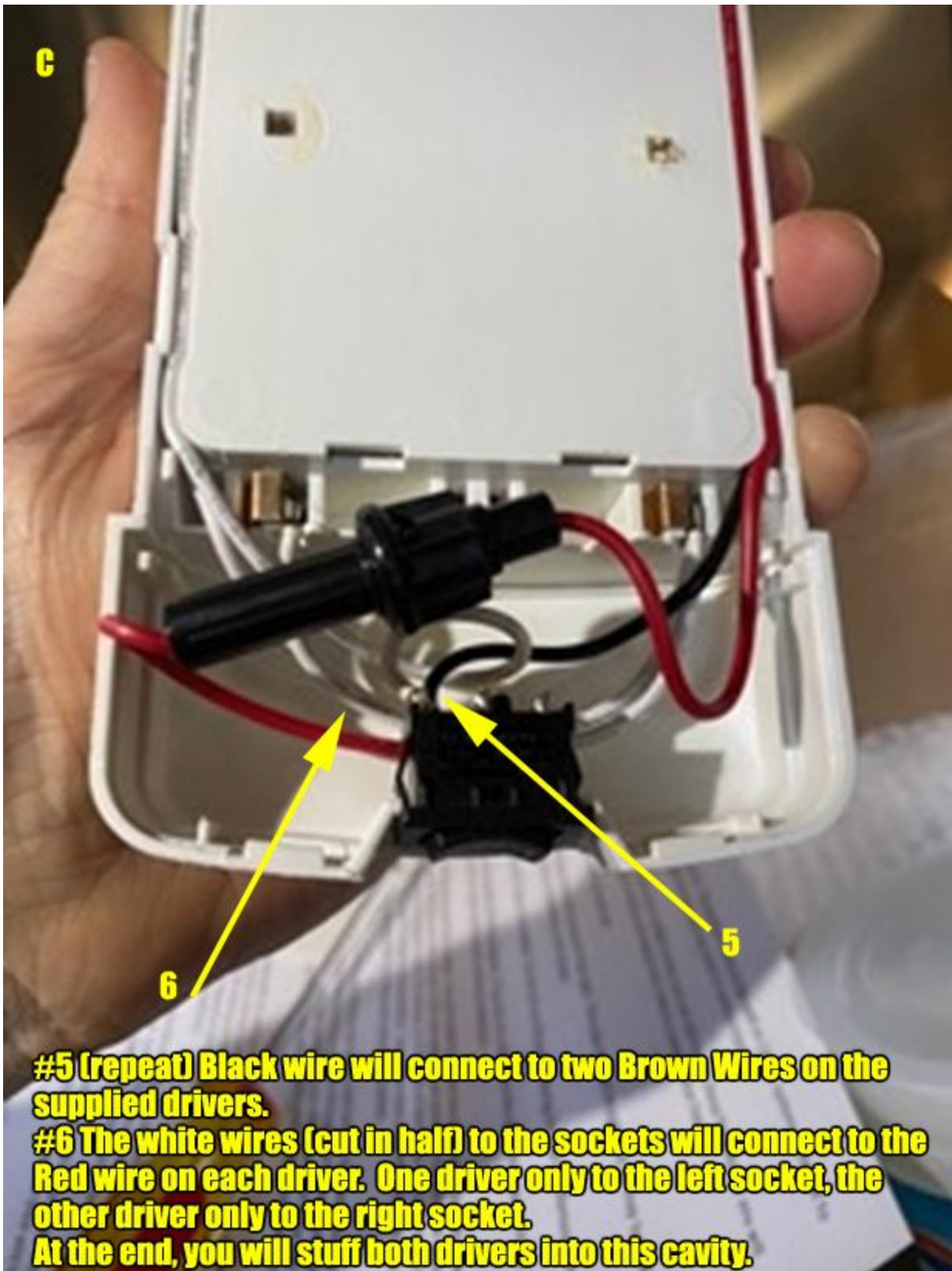



**D**

**The Blue Wires from the drivers need to go to the sockets at the other end of the fixture.**

**The black wires from the drivers need to go to the other end of the fixture too and connect to the black wire to the coach along with the second wire from the festoon.**

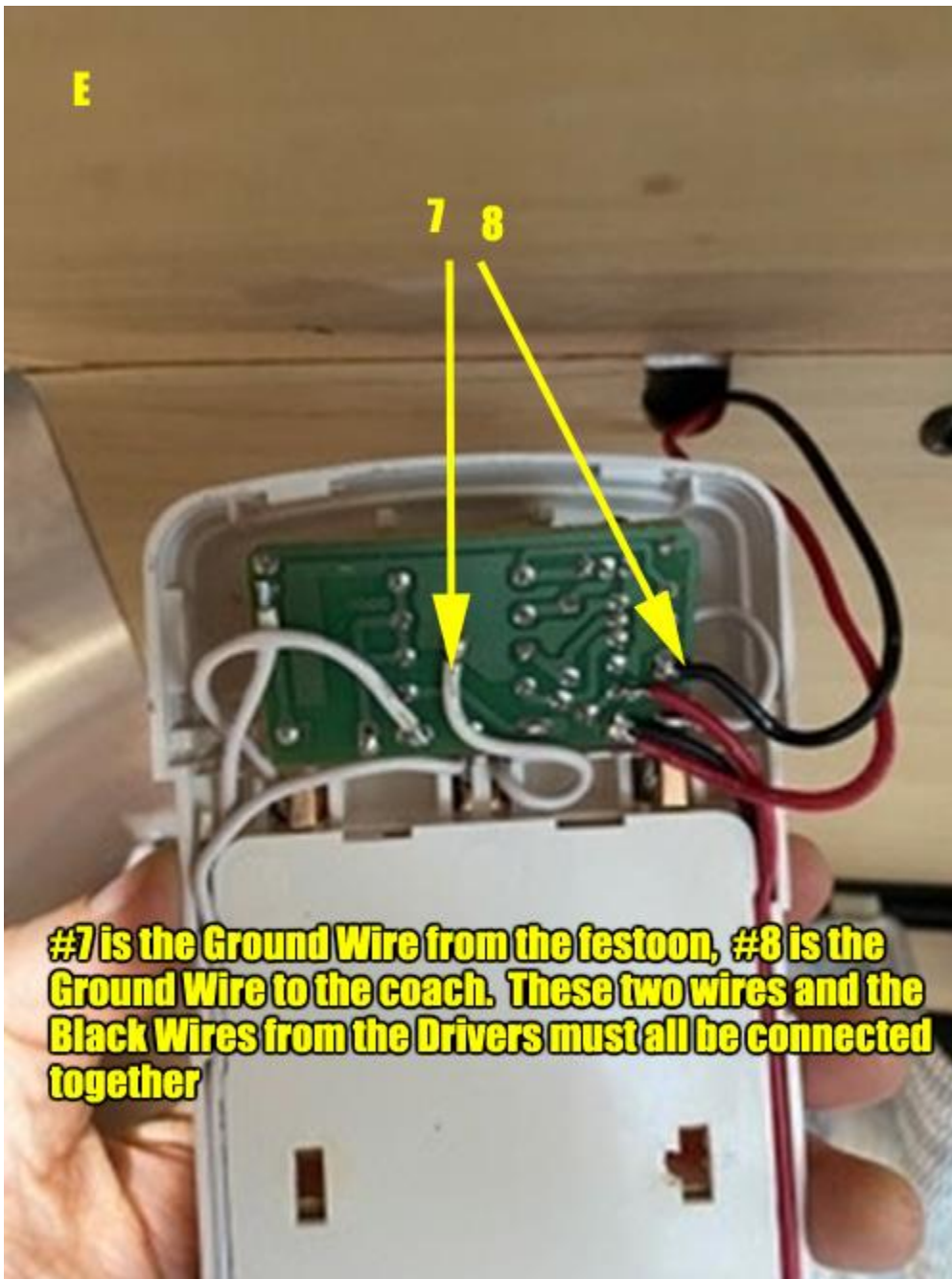

F

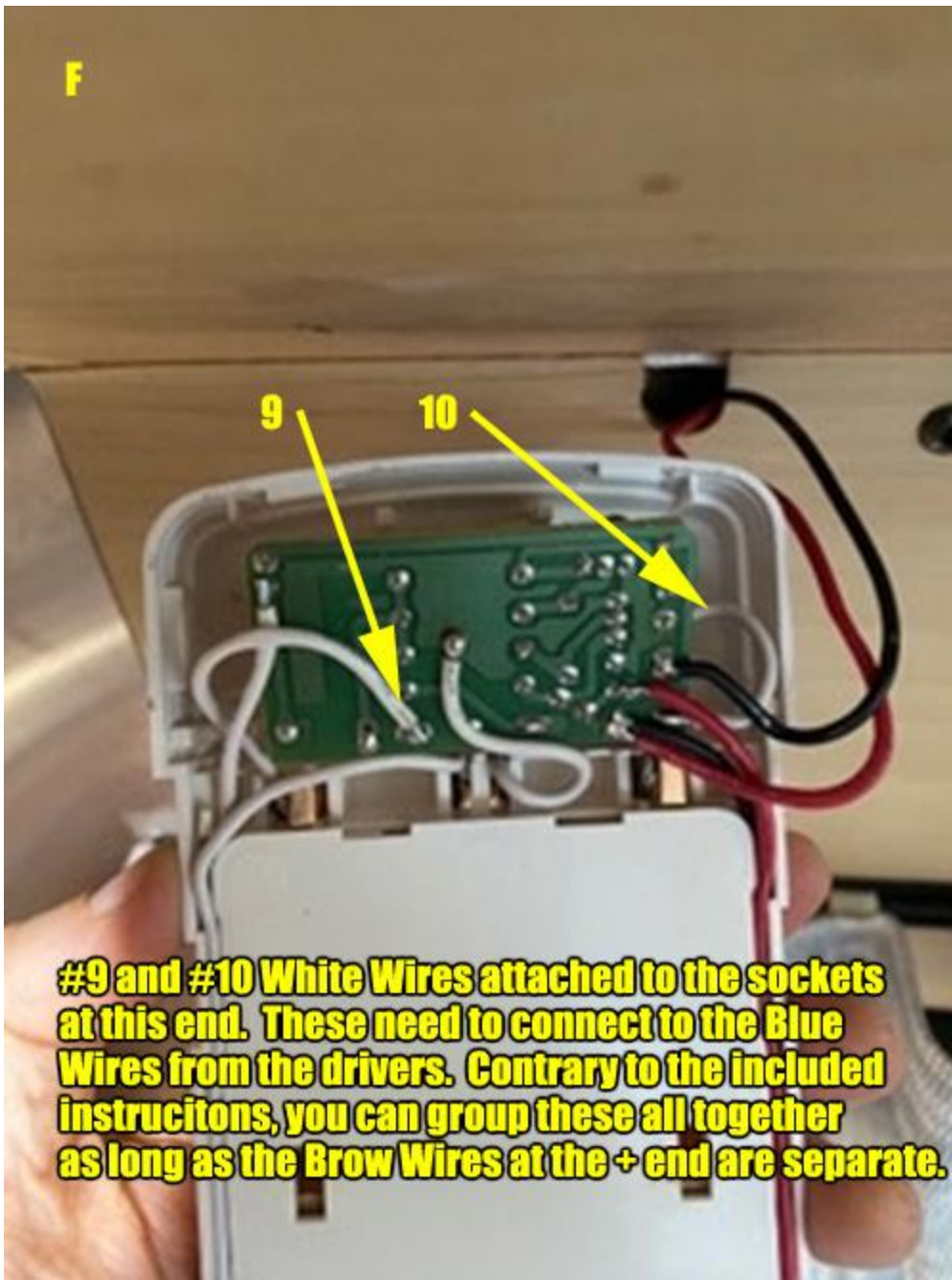

**#9 and #10 White Wires attached to the sockets at this end. These need to connect to the Blue Wires from the drivers. Contrary to the included instructions, you can group these all together as long as the Brown Wires at the + end are separate.**