

M4LED.com RETROFIT INSTRUCTIONS

P/N RETROFIT-12-5050 fits CE 001-57 and other Fixtures

DISCLAIMER: To install these retrofit lights, you will be replacing the LED module within your existing light fixture. You will be cutting and splicing wires that will void your warranty on your original light fixture. Though this is an easy rewire, if you are not comfortable with basic wiring, please seek a professional's assistance. M4 shall not be accountable for any damage to the existing light fixture or damage caused by shorts, loose wires, or mis-wiring. If you do not want to alter your light fixture, **STOP NOW**.



1. Turn the power off to the fixture. It is recommended to shut off your Main Battery Switch. Remove the lens cover by turning it 1/4 of a turn counter clockwise.
2. Remove the light fixture from the ceiling. Fixtures may be held in place by screws (visible on the flange if present) or spring clips on the back of the fixture (or both). To remove a fixture with spring clamps, you need to pull downward firmly on the fixture and the spring clamps will spread and come through the hole in the ceiling. Be aware that once they clear the ceiling they will spring with force back into their original position (like a mousetrap, watch your fingers).
3. The fixture may be wired to the coach in several ways. Use your discretion and detach the fixture from the ceiling. If using wire cutters, leave as much length of wire coming from the coach as possible to make it easier to reattach and reinstall the fixture.

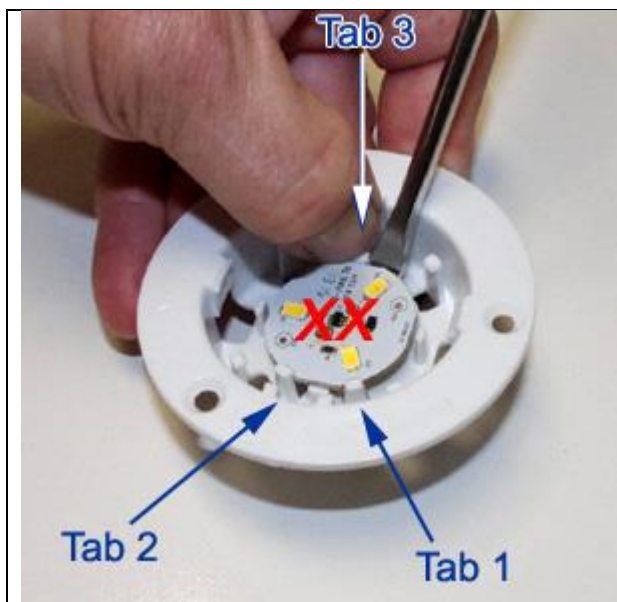

4. The LED module is held in place with three plastic tabs, two are close together. You will pull back the single tab (Tab 3 in picture) just enough to release the edge of the LED plate. Be careful not to pull the tab back too far as it is plastic and could break. This is a tight area so the easiest way is to push on the tab with a finger as shown and at the same time leverage the plate up with a small screwdriver.
5. Remove the LED plate from the fixture.

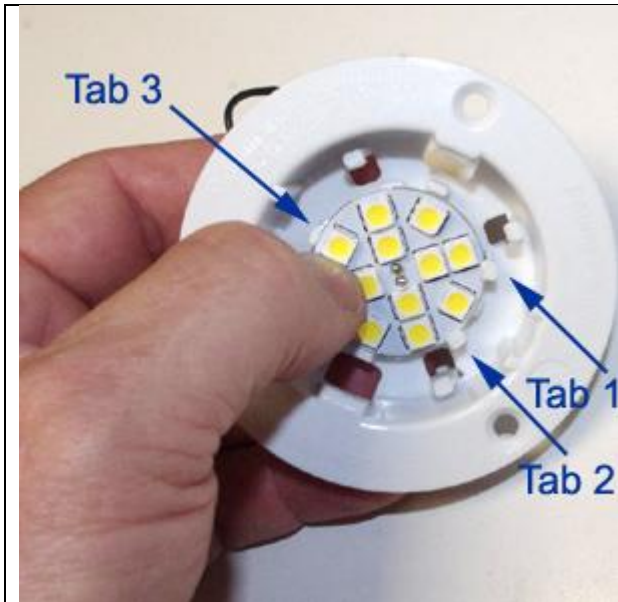

6. Install the new plate into the fixture. Put the wires through the center hole in the back of the fixture, then line up the plate on the two close tabs (Tab 1 and Tab 2). Ensure the plate is just below the clips on the tabs, but still above the block between the two clips. The plate should be positioned as shown.
7. Slowly and firmly press the plate near Tab 3 until it clicks into place.



8. The plate should look like this when installed properly.

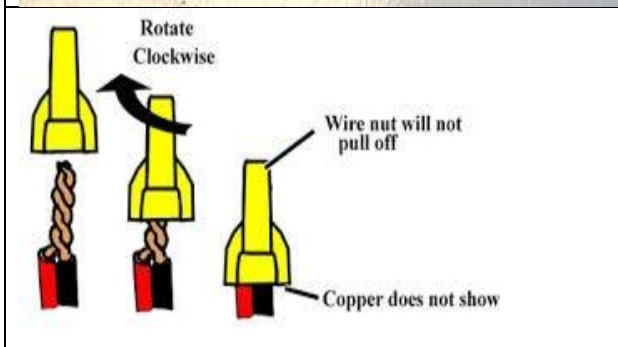

9. Reconnect the wires from the fixture to the coach. You may use the included blue wire nuts, or alternatively, you may use crimp connectors or solder and heat shrink. If soldering, ensure heat is not travelling down the wires to the LED circuit board.

10. Test the lamp prior to installing it into the ceiling. Once tested, turn the power back off and install the lamp into the ceiling. For Spring Clip installation, pull the spring clips as far back and together as possible behind the fixture, slide them into the ceiling hole, and slowly release them and push the fixture into position. Reinstall your lens cover to the fixture but pushing it up and turning it 1/8 of a turn clockwise.